

CERTIFIED RECORD OF LAND CORNER MONUMENTATION

History of original corner establishment:
New corner

*

DIAGRAM
T10S R32E
N1/16
S14/S13

Description of corner evidence found:

Description of monument and accessories I establish to perpetuate the original location of this corner:

Set a 2-1/2x30" aluminum monument 22" in the ground in a mound of stone.

New BTs:

A 9" Pine bears N14°40'W 9.4 ft scribed N1/16S14BT.

A 9" Pine bears S23°49'E 26.3 ft scribed N1/16S13BT.

T10S R32E
N1/16
S14/S13
PLS1918
1989

New BTs have 3/4" brass washers marked PLS1918 attached to the BT blaze, faces and bands painted with red tree marking paint, and BT tags and Attention or Land Survey Monument signs. A steel fence post with Attention or Land Survey Monument sign is driven approximately 3-5 feet from the corner.

Sun Cadastral Survey
Contract No.: 53-04H1-7-4011
Project No.: 8722LB
Field Book: 7-69
Work Accomplished: 6/6/89
Witnesses: Louise Parsons

PARSONS SURVEYING
1915 S.E. Stone Street
Corvallis, OR 97333
(503) 752-7515

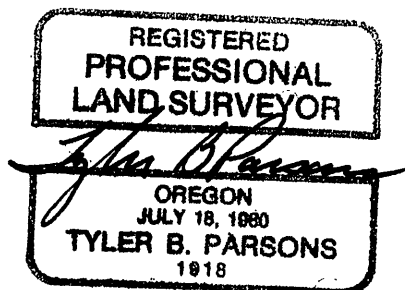

Office of COUNTY SURVEYOR County of GRANT
State of OREGON, I hereby certify that the within instrument was filed in this office
for record on the 10 day of Aug, 1989

Robert D. Regent by _____
(COUNTY OFFICIAL) (DEPUTY)